



DC BRUSHLESS MOTOR TECHNOLOGY

Automatic Door System

GATE TECH



Slim Mechanism

It provides the opportunity to apply in tight spaces



Electromecanic Lock System

Step motor lock ensures continuous operation



Digital Keypad

LED Screen Keypad



DC Brushless Motor

Quiet operation with brushless motor usage



Gate Tech GT 100S sliding door mechanism all available door It can be used in different applications in accordance with its profiles. Perfect operation thanks to its many adjustment possibilities It has characteristics and can be maintained very easily. Intelligent microprocessor controller guarantees safe operation, provides fast and smooth movements. All depending on European standards meets safety needs. Input of all parameters digital position It can be done quickly and easily by means of buttons on the switch screen. Its work is very practical. No additional programming device is required.

GT 100 S

GATE TECH

Automatic Door System with BLOC Motor and Driver



Battery System

Ability to leave the door
Open in an emergency



Replaceable Rail Streamer

Enables Change in Wear



Kapı parametreleri

1- Tek kanat kayar kapı	
• Geçiş açıklığı	700 - 1600 mm
• Maks. kanat ağırlığı	1 x 100 kg
2- Çift kanatlı kayar kapı	
• Geçiş açıklığı	700 - 2400 mm
• Maks. kanat ağırlığı	2 x 100 kg

Teknik Özellikler

Yükseklik	70 mm
Derinlik	120 mm
Açılma ve kapanma gücü maks.	150 N
Açılma hızı	10 - 80 cm / s
Kapanma hızı	10 - 50 cm / s
Açık kalma süresi	0,5 - 30 sec.
Besleme gerilimi, frekansı	230 V, 50 / 60 Hz
Enerji tüketimi	180 W
Koruma sınıfı	IP 20
Alçak gerilim	
ISO9001:2000'e uygun olarak üretim	

Kontrol ünitesi

Mikroişlemci kontrolör
Programlama seçenekleri
- Kapalı
- Otomatik
- Sürekli açık
Acil durdurma
Akıllı mikroişlemci
Otomatik geri açılım
Fotosel bağlantısı (maks. 2 çift)
Temel parametrelerin ekran ve butonlar vasıtasıyla kaydedilmesi
Harici kullanım için 24V çıkış
Hata kodlarını gösteren okuyucu

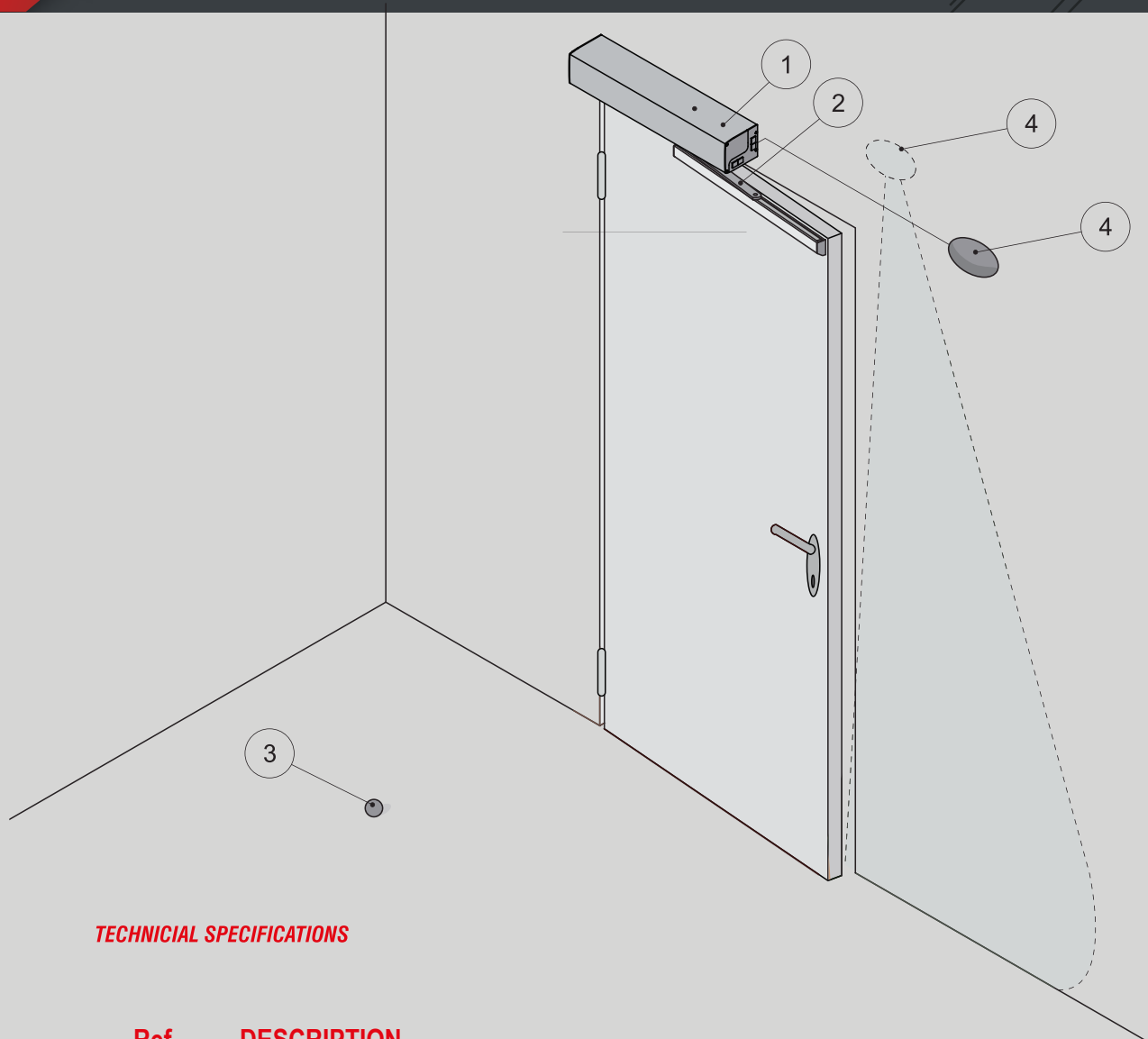

TECHNICAL SPECIFICATIONS

Ref	DESCRIPTION
1	Mechanism
2	Articulated movement arm Sliding movement arm Articulated movement arm with three levers End stop for articulated arm
3	End stop on the ground
4	Opening sensor

TECHNICAL SPECIFICATIONS

Capacity	200 kg
Opening angle	70° - 115°
Closing time	0.5 sec - 10 sec
Opening speed	150-450 mm / sec
Closing speed	100 - 430 mm / sec
Engine type	24V 55 W DC motor
Feed	AC220-250V. 50Hz-60Hz
Consumption	1A

GT 200 E Swing Door System



A Class Energy Efficiency

Gate Tech GT 200 N

Gate Tech GT 200 N is a new and comfortable way of opening doors safely and again without spending effort. Automatic, silent, safe operation of the doors it provides. An ideal helper for everyone during the day. It is impressive with its high technology as well as its small and elegant design. It's quite easy to start. All kinds it offers different forms of use according to your needs. In addition to this, all this comfortable and safe operation is easy to install and ready to operate.

All the different automatic doors are available in different models to suit different working needs for all 90° opening doors.

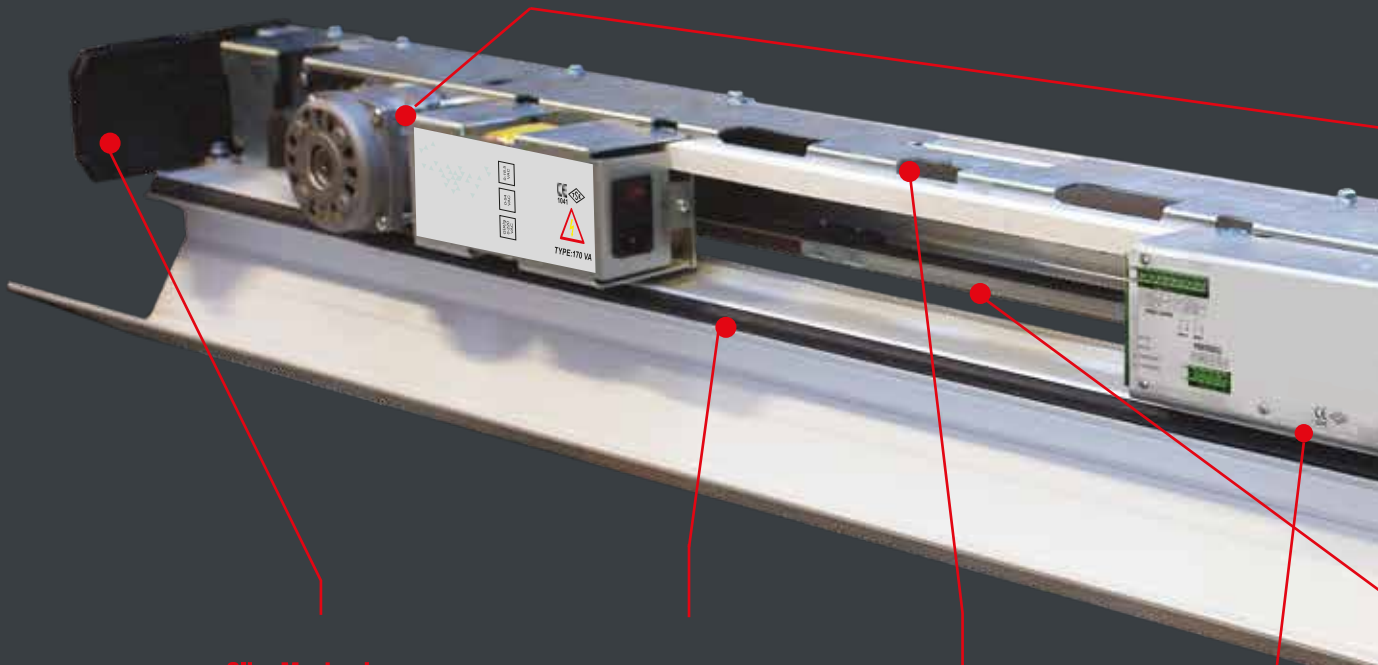

Slim Mechanism

It provides the opportunity to apply in tight spaces



Rubber Hinged Cover

It enables easy maintenance



Digital Keypad

LED Screen Keypad



VVVF Control Drive Unit

32-bit Microprocessor and exclusive inverter technology with independent adjustment of voltage and frequency

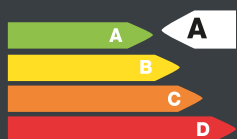

A Class Energy Efficiency

GEARLESS vvvf

GT 300 T TECHNOLOGY

Design and elegance in a 10 cm header frame

Fast and easy installation

A unique inverter technology exclusive of Schmelz provides independent adjustment of force and speed (WF)

Three phase AC motors without reduction gear, to guarantee a silent operation

Electronic board with 32-bit microprocessor

The movement of the wings are provided with double motors

The system automatically recognizes the initial opening distance.

Delay Time can be set to 0-30 sec.

Opening and closing speed adjustment can be made from keypad

GT 300 T SAFETY

Photocells placed on the radar of the remaining obstacles to contact domain object in this region

Wings open automatically to battery power outage

Independent adjustment of parameters: opening speed, closing speed, closing force, hold-open time, closing delay time

Continuous self-monitoring with immediate alert of malfunctions via digital display

Electronic automatic lock

System warranty for 2 years

It may change when the wheels on the rails toured the vaccine

GT 300 X

GATE TECH

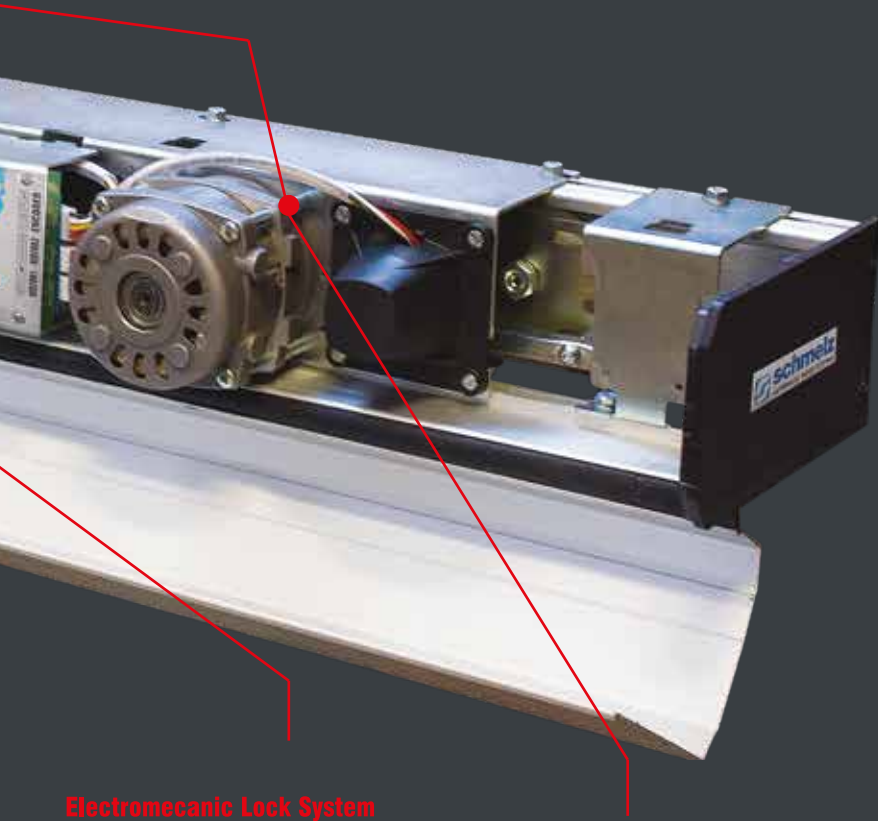

First and only gearless,
dual motor automatic door
system in Türkiye

Electromecanic Lock System

Step motor lock ensures continuous
operation



Gearless Twin Motor System

Provide quiet operation with gearless



GT 300 T +2 MOTOR

GT 300 T +1 MOTOR

TECHNICAL SPECIFICATIONS	Double Leaf	Single Leaf	Double Leaf	Single Leaf
Operator height	100 mm	100 mm	100 mm	100 mm
Maximum clear opening	2000 mm	1400 mm	2000 mm	1400 mm
Minimum pass opening	1200 mm	900 mm	1200 mm	900 mm
Maximum weight per leaf	2x150 kg	1x150 kg	2x75 kg	1x100 kg
Opening speed	100 - 150 cm/s	100 - 150 cm/s	100 - 150 cm/s	100 - 150 cm/s
Closing speed	30 - 80 cm/s	30 - 80 cm/s	30 - 80 cm/s	30 - 80 cm/s
Closing force	40-150 N	40-150 N	40-150 N	40-150 N
Acceleration	1.2 m / s ²	1.2 m / s ²	1 m / s ²	1m / s ²
Hız ve gücü bağımsız ayarlayabilme	✓	✓	✓	✓
Maksimum pass height	2400 mm	2400 mm	2400 mm	2400 mm
Maksimum Tüketim	150 W	150 W	75 W	75 W

GT 600 Y Linear Automatic Door System

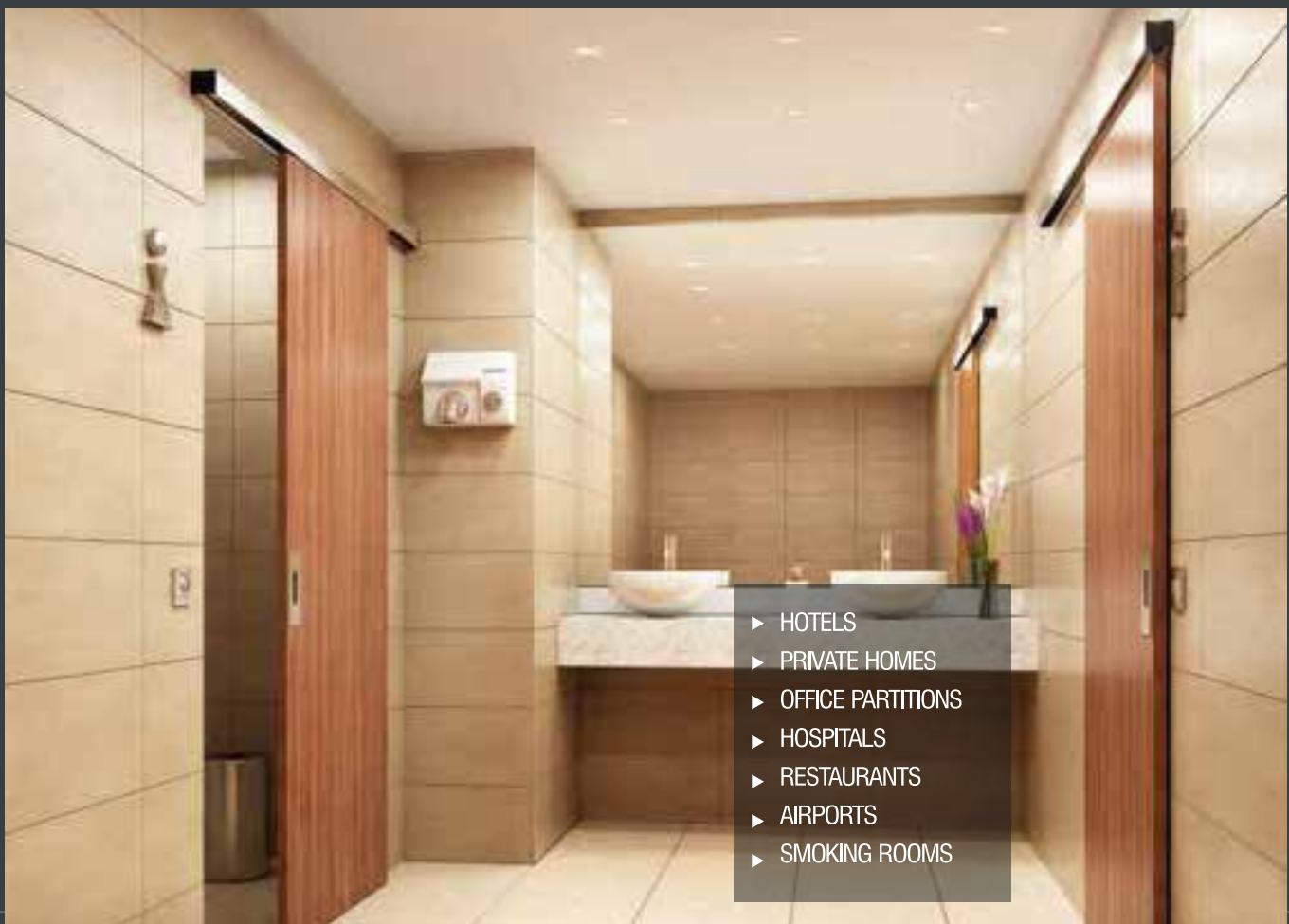

- ▶ HOTELS
- ▶ PRIVATE HOMES
- ▶ OFFICE PARTITIONS
- ▶ HOSPITALS
- ▶ RESTAURANTS
- ▶ AIRPORTS
- ▶ SMOKING ROOMS

Gate Tech GT600 S Advantages

- ▶ Innovative A step ahead of all other known technologies
- ▶ Elegant and stylish Compact size
- ▶ Quick to install Real "Plug-n-play"
- ▶ Reliable Less mechanical parts, less wear
- ▶ Easy to maintain Less mechanical elements: no pulleys, belts and motors...
- ▶ Safe and durable Complies with TS EN 16005 - DIN 18650
- ▶ Provides a carrying capacity of 90 kg



1. Automatic Lock



2. Remote Control



5. Infrared sensor



3. Touch-less Switch



4. Push Button



A Class Energy Efficiency

GT 600 Y

GATE TECH



LINEER MOTION TECHNOLOGY

**NO BELT
MOTOR**

A Linear motor is an electrically-powered motor that instead of rotating it produces a linear force along its length. Thrust is caused through the interaction of magnetic fields within the motors, by magnetic attraction and repulsion. Unlike traditional drive units, a linear motor drive does not have pulleys, belts, arms and other mechanical elements, resulting in a very compact and stylish housing of 50 x 55 mm, very appropriate for indoor use. The installation process is simplified, while maintenance costs reduce dramatically compared to traditional technologies using DC motors.

First and only ,
magnetic automatic door
system in Turkiye

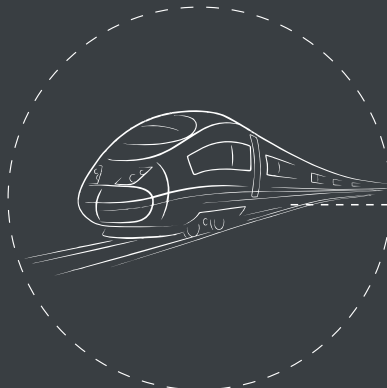

*Magnetic Used In High Speed Trains
Ray Technology is Used.*

HERMETIC Hygiene Door System



First and only gearless,
twin motor hermetic door
system in Türkiye

Gate Tech Hermetic Doors Suitable Environments :

- ▶ Hospitals
- ▶ Health Centers
- ▶ Operating Rooms
- ▶ Radiology Rooms
- ▶ White Rooms
- ▶ Pharmaceutical Industry
- ▶ Recording studios and sound-insulated environments
- ▶ Electronic Laboratories
- ▶ Analysis laboratories (medicine and / or chemistry)

Extremely Quiet

Thanks to the anti-vibration seal, all versions are extremely quiet, so comfort and quietness are ideal for use in the required environment.

Maximum Hygiene

The rounded aluminum body and screws prevent visible dust accumulation and provide cleanliness. Automatic doors can be used for both hygiene and physicians. It must be in a capacity to meet security requirements.

Maximum Security

The automation system can integrate "invisible" sensors that detect objects and people on the wing. Sensors outside the catheter. It also prevents dust from accumulating in the items. It also prevents the wing from accidentally hitting people or objects, not only in the transit line, but also in the movement of the wings. They provide complete security. Sensors are especially important in the stretcher and wheelchair passages that may not be perceived by traditional photocells.

Maximum Capacity

The radiology industry's needs for the use of heavy door wings guarded by lead inserts against X-rays are excellent with the Leaded Wing version.

Surface Diversity

Automatic Schmelz Hermetic door entrances are supplied with all RAL colors, anodised coatings and HPL laminate coatings in the Abet / Print color gamut. In addition, Schmelz Hermetic can be manufactured with scotch brite surface AISI 304 inox frames and wings.

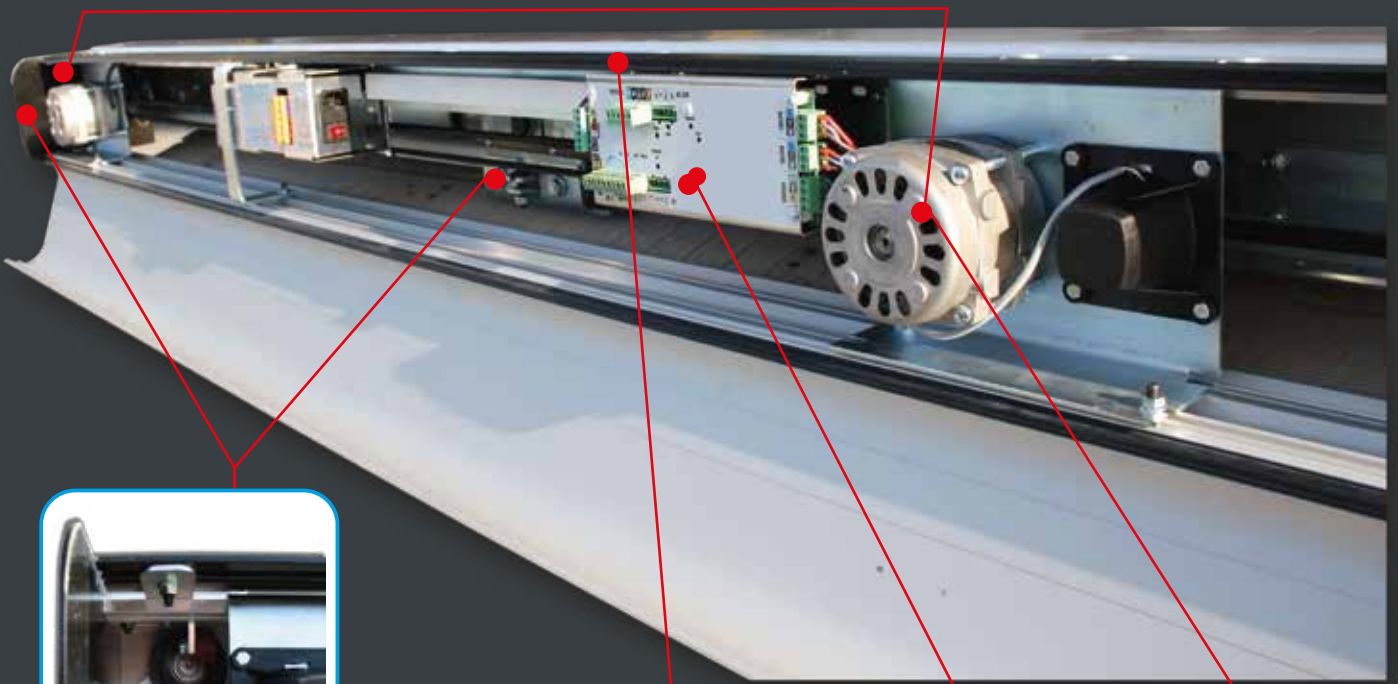

Hareketli Taşıyıcı Ray Sistemi

Stainless panel closing point
In moving rails 7mm down and
7mm forward.

Digital Keypad LED Screen Keypad



VVVF Control Drive Unit

32-bit Microprocessor and exclusive inverter
technology with independent adjustment
of voltage and frequency



Gearless Twin Motor System Provide quiet operation with gearless

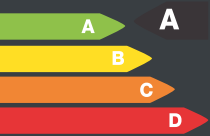

A Class Energy Efficiency

GEARLESS VVVF

GATE TECH HERMETIC

Antibacterial hygienic room doors used in operating rooms and intensive care units in hospitals. A hygienic space and effective isolation required One of the most important features of the hermetic doors used in places is to protect the conditions in the rooms with special climate such as the operating theater Provides

- ▶ The single wing width can be at least 700 mm (700 mm x 1 wing) maximum 2000 mm (2000 mm x 1 wing).
- ▶ There is a motor that is capable of opening millions of times with high torque.
- ▶ The motors have the automatic reverse operation feature to prevent the wings from jamming.
- ▶ With the encoder system, the position of the blades can be adjusted with the distance measuring system.
- ▶ With the power-position and Accelerometer you can adjust the micro-processor door wing weight.
- ▶ Each door has a safety photocell as standard.
- ▶ Parameter setting can be done easily with digital display and buttons on the microprocessor.
- ▶ With the digital display on the digital control panel connected to the microprocessor, error codes can be seen and easy service is possible.
- ▶ Mechanism Height 280, Depth 180 mm.

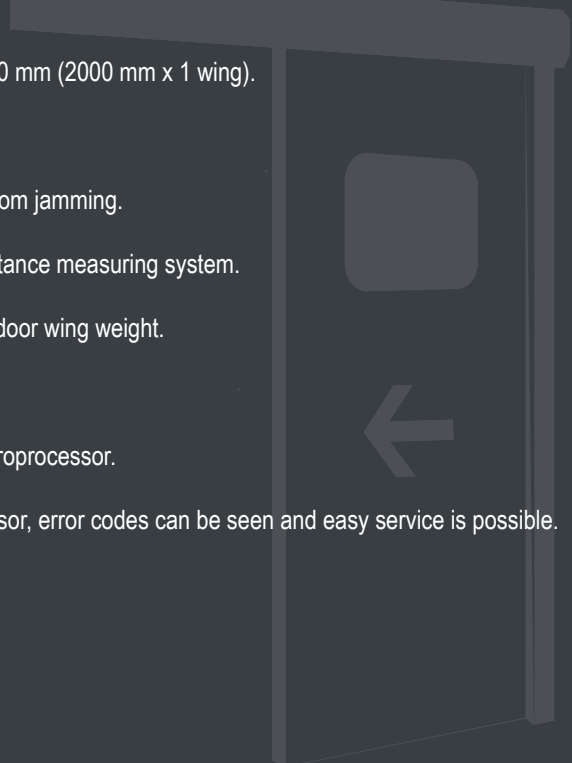

GT 800 T2

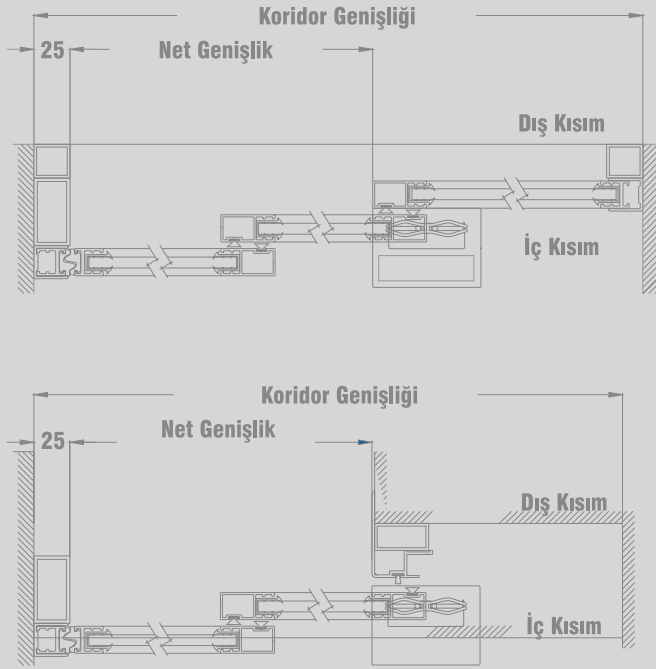

gearless,
double motor 2 frames
telescopic automatic door
system in Türkiye

GENERAL SPECIFICATIONS

- ▶ It is the telescopic automatic door system which operates on Single Rail as the first and the only in Turkey.
- ▶ It provides a perfect relationship, width and openness in the desired transition area.
- ▶ It provides quiet, solid and smooth operation.
- ▶ Includes special guidance systems for floors.
- ▶ Numerous input sensor options and accessories are available.
- ▶ It can operate synchronously with alarm and safety systems.

GT 800 T2 +2 MOTOR

GT 800 T2 +1 MOTOR

TECHNICAL SPECIFICATIONS	Çift Kanat / Double Leaf	Çift Kanat / Double Leaf
Operator height	100 mm	100 mm
Maximum clear opening	2000 mm	2000 mm
Minimum geçiş açıklığı	1200 mm	1200 mm
Maximum weight per leaf	2x100 kg	2x75 kg
Opening speed	100 - 150 cm/s	100 - 150 cm/s
Closing speed	30 - 80 cm/s	30 - 80 cm/s
Closing force	40-150 N	40-150 N
Acceleration	1.2 m / s ²	1 m / s ²
Ability to adjust speed and power independently	✓	✓
Maksimum pass height	2500 mm	2500 mm
Maximum consumption	150 W	75 W

GT 800 T2

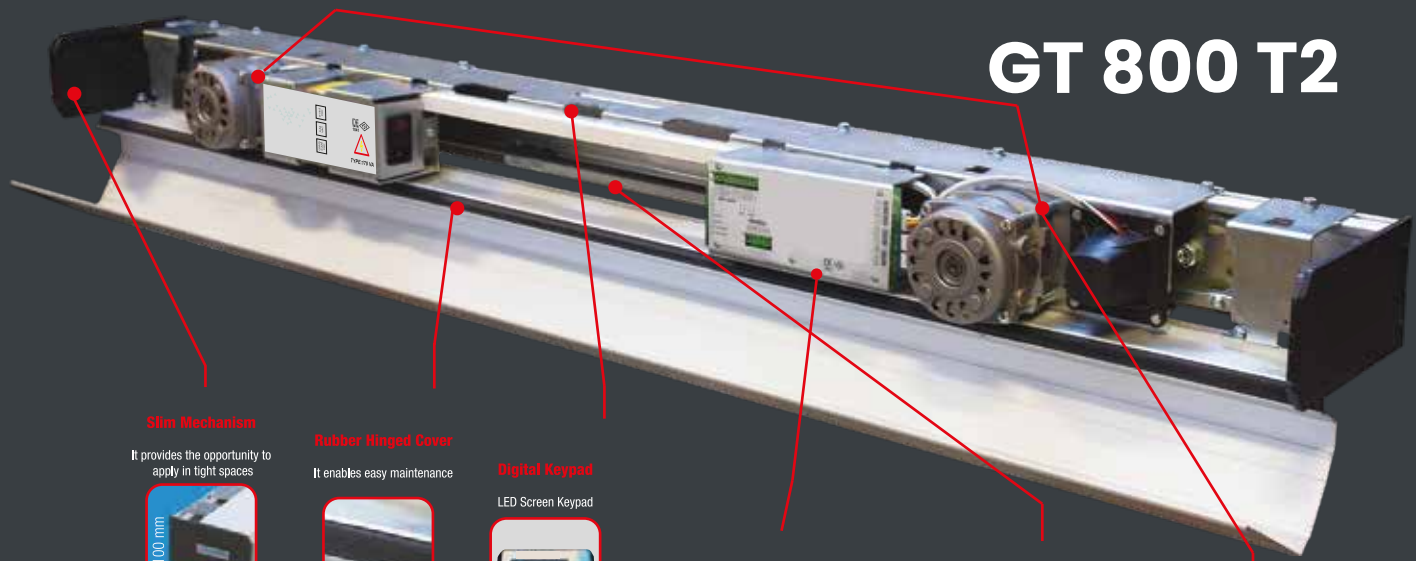

Slim Mechanism

It provides the opportunity to apply in tight spaces



100 mm

Rubber Hinged Cover

It enables easy maintenance



Digital Keypad

LED Screen Keypad



VVVF Control Drive Unit

32-bit Microprocessor and exclusive inverter technology with independent adjustment of voltage and frequency



Electromechanic Lock System

Step motor lock ensures continuous operation

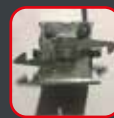

Gearless Twin Motor System

Provide quiet operation with gearless



A Class Energy Efficiency

GEARLESS VVVF

GATE TECH GT 800T2

It is used to gain more space and create a wider door space if the location is narrow. In addition, maximum operation safety is achieved by continuous control of the closing force of the door system. The telescopic doors on one side are made up of 3 kanads. One of them is the fixed wing (yada wall) and the other two wings are movable. (With elevator doors as an example), two pieces of canapes sliding on each other in the same direction.

- ▶ Two Pieces There is a motor that is capable of opening millions of times with high torque.
- ▶ The motors have the automatic reverse operation feature to prevent the wings from jamming.
- ▶ With the encoder system, the position of the blades can be adjusted with the distance measuring system.
- ▶ With the power-position and Accelerometer you can adjust the micro-processor door wing weight.
- ▶ Carrier rail profile is carried on one rail
- ▶ Parameter setting can be done easily with digital display and buttons on the microprocessor.
- ▶ With the digital display on the digital control panel connected to the microprocessor, error codes can be seen and easy service is possible
- ▶ Mechanism Height 100 mm, Depth 170 mm.

ANTI-PANIC BREAK-OUT SYSTEM

The SAP system is an essential accessory for the realisation of automated entrances fitted on safety exit passage ways. The SAP system is a combination of components purposely designed to facilitate assembly on the aluminium or iron profiles that have to be used when realising automated sliding and semi-fixed leaves that open by breakout if pushed towards the escape route. Four different types of kits can be supplied:

- ▶ SAP1 - for one sliding leaf
- ▶ SAP 2 - for two sliding leaves
- ▶ SAP 1+1 - for one sliding leaf and a semi-fixed leaf
- ▶ SAP 2+2 - for two sliding leaves and two semi-fixed leaves

Every kit is supplied complete with the safety accessories provided by the current rules, such as photocells and/or magnetic microswitches that are necessary to stop the operation of the automated system in the event of a breakout through the leaves.

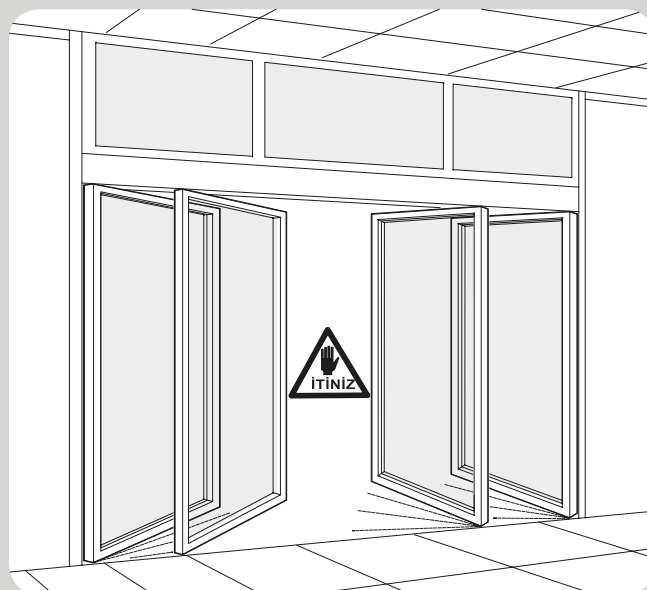

DESCRIPTION OF COMPONENTS

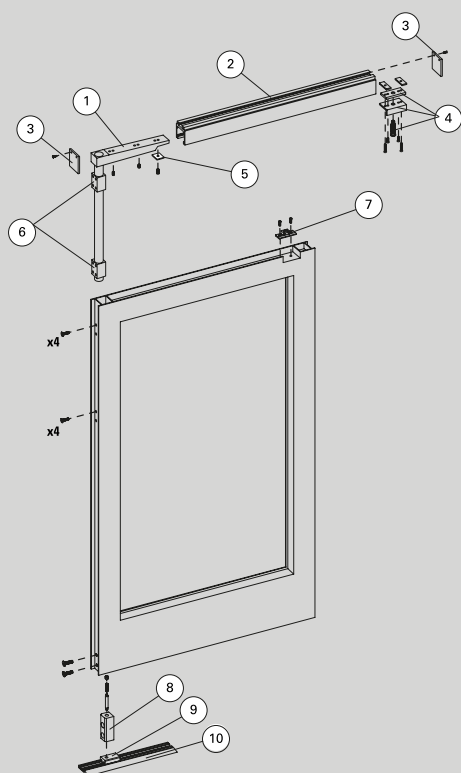

Ref.	DESCRIPTION
1	Anti Panic Hinge
2	Top Profile
3	Closing Plugs
4	Mobile Leaf Anti Panic Release Unit
5	Leaf Adjustment Block
6	Anti Panic Hinge Bush
7	Hook On Block
8	Slide Support
9	Slide
10	Sliding Guide

FIRE RESISTANT SYSTEM



The status of your conversion is automatically updated on this page. If you don't want to wait and would like to be notified by email then click on the notify link next to each file and enter the email address to which you want the notification to be sent.

Once a file is successfully converted, it will be available for download for up to 24 hours, after which the file will no longer be accessible. You can also delete the converted file by pressing the delete button.



First and only ,
fire resistant automatic door
system in Turkiye

FIRE RESISTANT SYSTEM

Gate Tech automatic doors are produced to provide a wide and clear opening for convenience, with a single-wing or two-wing opening automatic door system. Schmelz fire-proof wings become fully fire-proof when closed. Schmelz fire-proof door as standard. It works as follows: The Schmelz fire resistant automatic door system automatically closes the wings in the event of a fire alarm. Closed but unlocked, allowing them to be opened manually at any time. Gaps when the temperature reaches the required level Special tapes swell and seal. The door has a certificate of conformity to the European Standard EN 13501-2: 2004. Elements according to the fire resistance performance obtained "relating to the "Building products and classification of construction" EN 1634-1: 2000, "Fire resistance tests for fire doors and shutter assemblies" on E160, E130, E90, E60 and E30 doors. The tests were carried out under the strict control of the Official Laboratories. The Gate Tech fire door was specially designed and manufactured.

E - INTEGRITY

This refers to the capacity of a construction element with a separating function to withstand exposure to fire on one side, without flames or hot gases being transmitted to the other non-exposed side, in such a way that ignition is avoided on the surface of said side.

Integrity is said to be achieved when flames and gases fail to appear on the non-exposed surface over a specific period of time:



I - INSULATION

This refers to the capacity of a construction element to withstand exposure to fire on only one side, thus preventing significant heat transfer to the other, non-exposed side.

Insulation is said to be achieved when the temperature fails to reach 180° at any particular point on the non-exposed surface, or does not exceed an average of 140° to be calculated by extrapolating the temperatures at different points of the non-exposed surface:



FIRE RESISTANT SYSTEM



GLAZING DETAILS: Glazings are specific to each different EI60, EI30, E60 and E30 classification, and have been tested along with the support element (rebate). It is an inviolable assembly.



FIRE RESISTANT SYSTEM

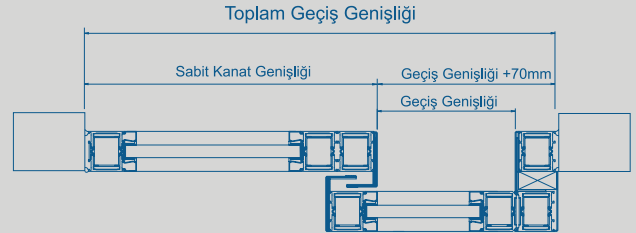
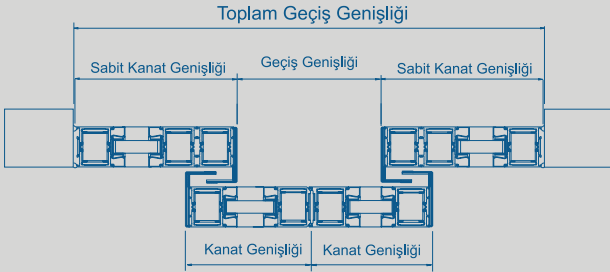
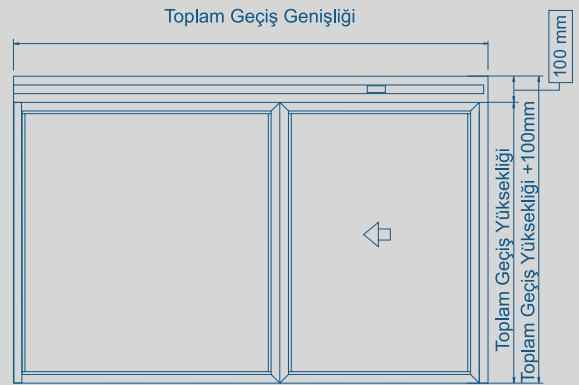
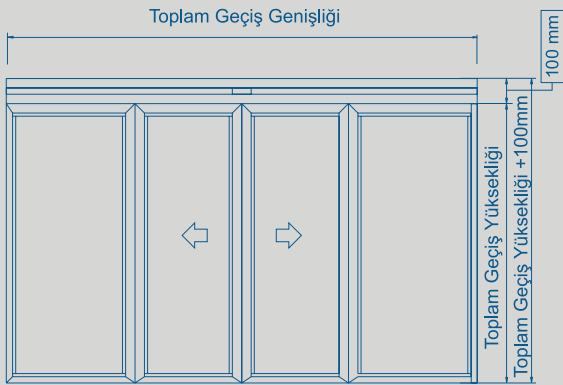
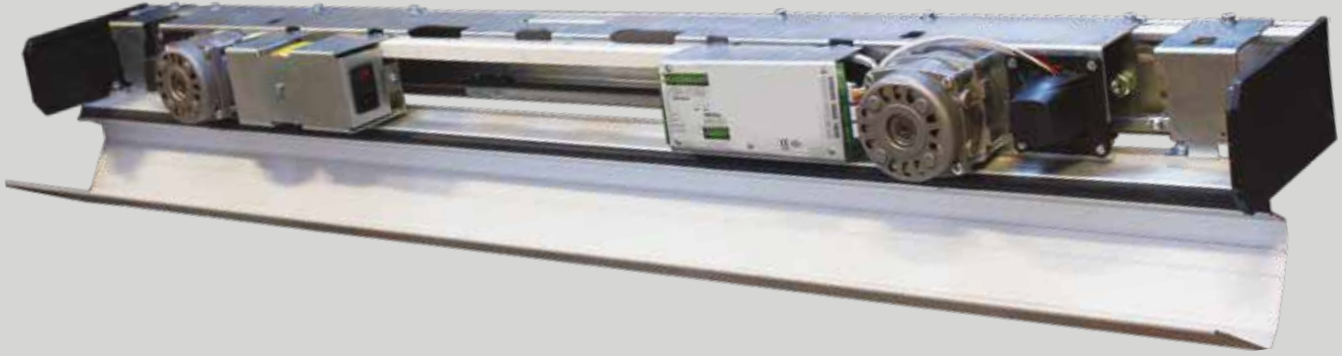

GT 300 T +2 MOTOR

GT 300 T +1 MOTOR

TECHNICAL SPECIFICATIONS	Double Leaf	Single Leaf	Double Leaf	Single Leaf
Operator height	100 mm	100 mm	100 mm	100 mm
Maximum clear opening	2000 mm	1400 mm	2000 mm	1400 mm
Minimum geçiş	1200 mm	900 mm	1200 mm	900 mm
Maximum weight per leaf	2x100 kg	1x140 kg	2x75 kg	1x100 kg
Opening speed	100 - 150 cm/s	100 - 150 cm/s	100 - 150 cm/s	100 - 150 cm/s
Closing speed	30 - 80 cm/s	30 - 80 cm/s	30 - 80 cm/s	30 - 80 cm/s
Closing force	40-150 N	40-150 N	40-150 N	40-150 N
Acceleration	1.2 m / s ²	1.2 m / s ²	1 m / s ²	1m / s ²
Ability to adjust speed and power independently	✓	✓	✓	✓
Maksimum pass height	2400 mm	2400 mm	2400 mm	2400 mm
Maximum consumption	150 W	150 W	75 W	75 W



Head Office: MVK Work-Square Yenişehir Mah.
Mustafa Akyol Sk. No:13 İç Kapı No: 22,
Postal Code: 34912 Pendik / ISTANBUL / TURKEY

Factory: Hasanaga Organize Sanayi Bölgesi
Hosab Caddesi No:33 Nilüfer / BURSA / TURKEY

T. +90 216 999 40 61

web: www.genadoor.com

e-mail: info@genadoor.com